

Notes:

1 Electrical

- 1.1 Impedance: 50Ω
- 1.2 Frequency: 0-6GHz
- 1.3 Working voltage: $\leq 335V$
- 1.4 Insulation resistance: $\geq 5000M \Omega$
- 1.5 Dielectric withstanding voltage: 1000V
- 1.6 VSWR ≤ 1.2

2 Material&Finish

- 2.1 Inner Contact: Beryllium copper, gold plated
- 2.1 Outer Contact: Brass, nickel plated
- 2.3 Insulators: PTFE

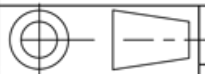

Scale

1:1

Name

Date

Designed Tomson Tang 31-May-13

Checked Jason Cai 31-May-13

Approved Teresa Shen 31-May-13

N/SMA-JK2
RF Adapter

UNLESS OTHERWISE SPECIFIED
DIMENSIONS ARE mm, TOLERANCES ARE:
FRACTIONS DECIMALS ANGLES
.X± .15 ±1°
.XX± .05
.XXX±



www.rf-connector-china.com