

Notes:

Electrical characteristics

1. Impedance: 50Ω
2. Working voltage: $\leq 250V$
3. Insulation resistance: $\geq 1000M \Omega$
4. Dielectric strength: $750V$
5. Contact resistance

Center contact $\leq 6m \Omega$
Outer contact $\leq 1m \Omega$

Material&Finish

Inner Contact: Beryllium copper, gold plated
Outer Contact: Brass, gold plated
Insulators: Teflon

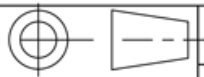

Scale

1:1

Name

Date

Designed

Tomson

19-Aug-11

Checked

Jason

19-Aug-11

Approved

Teresa

19-Aug-11

SMB-KW3
RF Coaxial Connector

UNLESS OTHERWISE SPECIFIED
DIMENSIONS ARE mm, TOLERANCES ARE:
FRACTIONS DECIMALS ANGLES
.X± .15 ±1°
.XX± .05
.XXX±



www.rf-connector-china.com