

P/N:TRL112C05

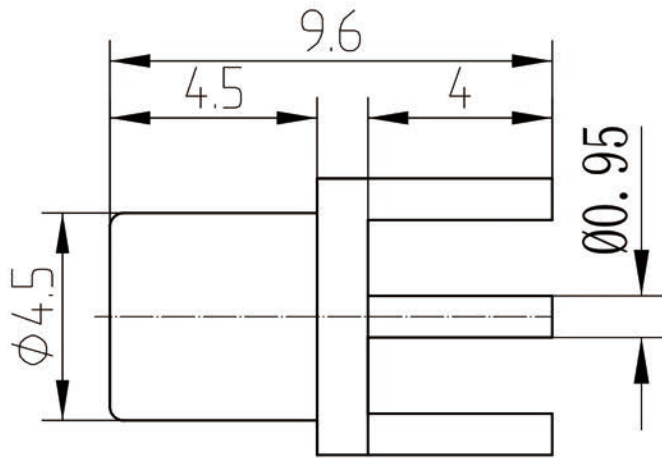

Recommended Mounting Hole

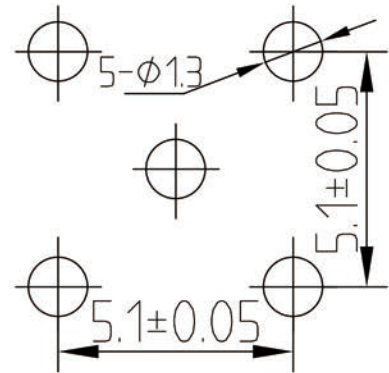

Electrical characteristics

- 1.1 Impedance: 50 Ω
- 1.2 Frequency: DC~6GHz
- 1.3 VSWR: 1.30:1

2 Material&Finish

- 2.1 Inner Contact: Beryllium Copper, gold plated
- 2.2 Outer Contact: brass, gold plated
- 2.3 Insulators: Teflon

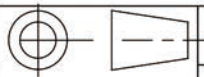

Scale

1:1

Name

Date

Designed

Tomson

14-Dec-18

Checked

Jason

14-Dec-18

Approved

Teresa

14-Dec-18

MCX-KHD4

RF Coaxial Connector



www.rf-connector-china.com

UNLESS OTHERWISE SPECIFIED
DIMENSIONS ARE mm, TOLERANCES ARE:
FRACTIONS DECIMALS ANGLES
.X± .15 ±1°
.XX± .05
.XXX±