

Electrical

1. Impedance: 50Ω
2. Frequency: $0 \sim 3\text{GHz}$
2. Working voltage: $\leq 250\text{V}$
3. Insulation resistance: $\geq 1000\text{M}\Omega$
4. Dielectric strength: 500V
5. Center contact resistance $\leq 5\text{m}\Omega$
6. Center contact resistance $\leq 2.5\text{m}\Omega$

Material & Finish

1. Inner Contact: gold plated over Brass
2. Outer Contact: gold plated over brass.
3. Insulators: Teflon
4. Crimp Ferrule: brass, gold plated

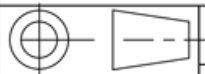

Scale

1:1

Name

Date

Designed

Tomson

4-Dec-15

Checked

Jason

4-Dec-15

Approved

Teresa

4-Dec-15

SSMB-JFD
SSMB Male Flange conn.
for Terminal

UNLESS OTHERWISE SPECIFIED
DIMENSIONS ARE mm, TOLERANCES ARE:
FRACTIONS DECIMALS ANGLES
.X± .15 ±1°
.XX± .05
.XXX±



www.rf-connector-china.com