

1 Electrical

- 1.1 Impedance: 50Ω
- 1.2 Working voltage: $\leq 335V$
- 1.3 Insulation resistance: $\geq 5000M\Omega$
- 1.4 Dielectric strength: $1000V$
- 1.5 Contact resistance
 - Center contact $\leq 3M\Omega$
 - Outer contact $\leq 2.5M\Omega$

2 Material&Finish

- 2.1 Inner Contact: gold plated over Brass
- 2.2 Outer Contact: gold plated over brass.
- 2.3 Insulators: Teflon

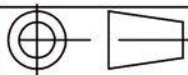

Scale

1:1

Name

Date

Designed

Tomson Tang

24-Oct-08

Checked

Jason Cai

24-Oct-08

Approved

Teresa Shen

24-Oct-08

SMA-J3C

SMA male conn. for RG316
cable (sky window)

UNLESS OTHERWISE SPECIFIED
DIMENSIONS ARE mm, TOLERANCES ARE:
FRACTIONS DECIMALS ANGLES
.X± .15 ±1°
.XX± .05
.XXX±



www.rf-connector-china.com