

Electrical

1. Impedance: 75Ω
- Frequency: 0~2GHz
2. Working voltage: $\leq 335V$
3. Insulation resistance: $\geq 1000M\Omega$
4. Dielectric strength: 1000V
5. Center contact resistance $\leq 6m\Omega$
6. Center contact resistance $\leq 1m\Omega$

Material & Finish

1. Inner Contact: Beryllium copper, gold plated
2. Outer Contact: brass, gold plated
3. Insulators: Teflon
4. Spring Contact: Beryllium copper, Gold plated

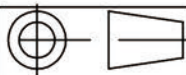

Scale

1:1

Name

Tomson

Date

16-Jun-15

Designed

Checked

Approved

Jason

16-Jun-15

Teresa

16-Jun-15

SMB-75KK1

SMB Female to Female Adapter

UNLESS OTHERWISE SPECIFIED
DIMENSIONS ARE mm, TOLERANCES ARE:
FRACTIONS DECIMALS ANGLES
.X± .15 ±1°
.XX± .05
.XXX±



www.rf-connector-china.com