

TRL10902E

This document contains proprietary information and such information may not be disclosed to others for any purposes, nor used for sales/marketing/procurement purposes without written permission.
 本文件包含专有信息，没有书面许可，该信息不能以任何形式披露给第三方，也不能用于任何目的的买卖、销售及采购。

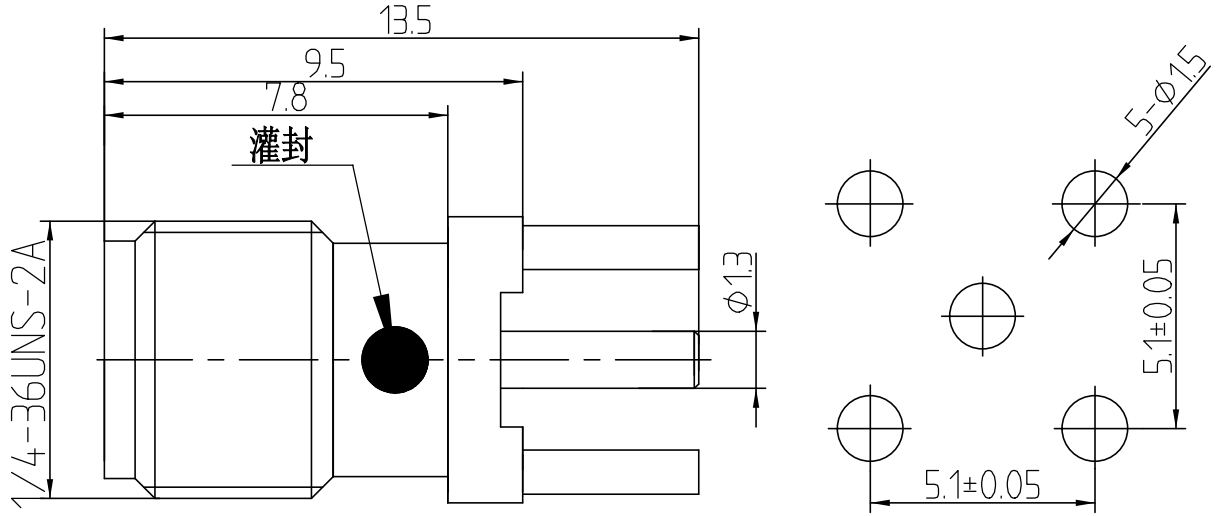

1 电气性能

- 1.1 阻抗: 50 Ω
- 1.2 工作电压: 335V(rms)
- 1.3 频率范围: DC-18GHz
- 1.4 绝缘电阻: 5000M Ω min
- 1.5 介质耐压: 1000V
- 1.6 中心导体电阻: 3M Ω max
- 1.7 外导体电阻: 2.5M Ω max

2 材料&涂覆

- 2.1 中心导体: 镀青铜, 镀金
- 2.2 外壳: 黄铜镀金
- 2.3 绝缘介质: Teflon

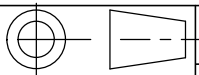

Scale

1:1

Name

Date

Designed

Michael Tang

17-Aug-10

Checked

Jason Cai

17-Aug-10

Approved

Teresa

17-Aug-10

SMA-KHD
射频频轴连接器

UNLESS OTHERWISE SPECIFIED
 DIMENSIONS ARE mm, TOLERANCES ARE:
 FRACTIONS DECIMALS ANGLES
 .X± .15 ±1°
 .XX± .05
 .XXX±

丹阳特瑞莱电子有限公司